



The right light



8315

Wave Plus

DESIGN: LUXO / D. SPRANGER

WAVE plus is the ideal magnifier for industrial applications. It is the only magnifier to offer both shadow-free magnification with light coming from both sides, as well as three-dimensional magnification with light coming from the left or right. The 3D-feature is especially welcome when working with circuit boards or similar delicate objects.



TECHNICAL INFORMATION 8315 Wave Plus

By illuminating from one side only, depth perception is increased and positioning of the objects are made easier. The large rectangular lens, 175 x 108 mm, permits comfortable viewing with both eyes. The slim edge in front of the lens ensures that eye contact with the object viewed is not lost when switching from magnification to normal viewing and back again. The neck joint between the head and arm moves in three planes: horizontally, vertically and laterally making exact positioning easy. A cloth cover is provided to protect the lens from dust and prevent the luminaire from inadvertently turn into a burning glass. For additional magnification, secondary lenses can be fixed to WAVE plus in seconds. A 10D swing-away lens is also available. It clamps onto the head and swings into action when needed.

Colours:



8315 Wave Plus

LUXO ASA, Drammensveien 175, N-0277 Oslo, Norway

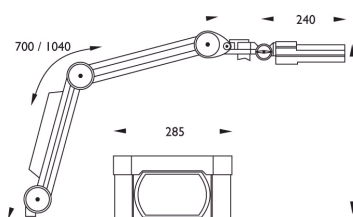

OPTIONS

WAVE PLUS

Article no.	Lamp socket	Ilcos	Power	Total effect	Weight	Voltage	Arm length	Lumen	lm/w	IP	Colour rendering	Colours
8315-27-2	G23	FSD	2x7	14W	4 kg	230/240V	1040 mm	400	28	20	85	<input type="checkbox"/>
8315-27-2B	G23	FSD	2x7	14W	4 kg	230/240V	1040 mm	400	28	20	85	<input checked="" type="checkbox"/>
8315-27-2G	G23	FSD	2x7	14W	4 kg	230/240V	1040 mm	400	28	20	85	<input type="checkbox"/>

ACCESSORIES

Accessory	Article number
Replacement lamp 7W FSD-I /840 2-PINS	06-969-111-00
Attachment lens WAVE plus, 4D	06-800-140-00
Attachment lens WAVE plus, 6D	06-800-130-00
Attachment lens, swing away, 10D	06-800-120-00
CC-bracket white. Surface mounted table bracket	8990-507-1
TE-bracket. Table bushing	8990-014-0
Floor stand/trolley in white	8990-028-1
CC-bracket black. Surface mounted bracket	8990-507-2
TT bracket, table bushing Ø80mm	8990-052-1

LENS DATA

Option	Diopter primary	Total magnification	Total Magnification %	Focal length	Lux
8315-27-2G		3.00	1.8	175%	333.3 1420

RELATED PRODUCTS



AH-table clamp
8990
Task light accessories



CC surface mounted bracket
8990
Task light accessories



TE table bushing
8990
Task light accessories



Trolley
8990
Task light accessories